

FMAC(M)3000

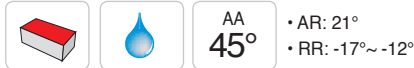
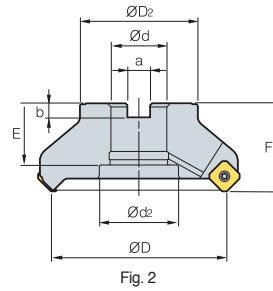
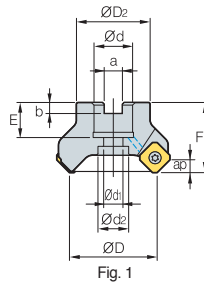

Designation		⊙	∅D	∅D ₂	∅d	a	b	E	F	∅d ₁	∅d ₂	ap	kg	Fig.
FMACM	3050HR	4	50	42	22	10.4	6.3	20	40	11	17.5	4.0	0.4	1
	3050HR-H	6	50	42	22	10.4	6.3	20	40	11	17.5	4.0	0.4	1
	3063HR	5	63	49	22	10.4	6.3	20	40	11	17.5	4.0	0.5	1
	3063HR-H	8	63	49	22	10.4	6.3	20	40	11	17.5	4.0	0.6	1
FMAC (FMACM)	3080HR	6	80	57	25.4 (27)	9.5 (12.4)	6 (7)	25 (23)	50	14	20	4.0	1.1	1
	3080HR-H	10	80	57	25.4 (27)	9.5 (12.4)	6 (7)	25 (23)	50	14	20	4.0	1.2	1
	3100HR	7	100	67	31.75 (32)	12.7 (14.4)	8 (8)	35 (25.5)	50	(18)	45 (26)	4.0	1.7	2 (1)
	3100HR-H	12	100	67	31.75 (32)	12.7 (14.4)	8 (8)	35 (25.5)	50	(18)	45 (26)	4.0	1.7	2 (1)
	3125HR	8	125	87	38.1 (40)	15.9 (16.4)	10 (9)	42 (29)	63	(22)	55 (32)	4.0	3.3 (3.5)	2 (1)
	3125HR-H	14	125	87	38.1 (40)	15.9 (16.4)	10 (9)	42 (29)	63	(22)	55 (32)	4.0	3.3 (3.5)	2 (1)

() Metric size

Available inserts



Designation	Cermet		Coated										Uncoated				page				
	CN2000	CN30	NCM325	NC5330	NCM535	NCM545	PC2505	PC2010	PC3600	PC3700	PC6510	PC9530	PC9540	PC5300	PC5400	ST30A		G10	H01	H05	
SEET	0903AGFN-MA																			E19	
	0903AGSN-MF																				E20
	0903AGSN-MM			●																	
SEXT	0903AGSN-MF							●		●				●	●						
	0903AGSN-MM							●	●	●				●	●						
	0903AGSN-MR																				
SEEW	0903AGTN																				

Available arbors

Designation	∅d	NC arbors
FMACM 3050HR-□	22	BT□□-FMC22-□□
3063HR-□		
FMAC (FMACM) 3080HR-□	25.4	BT□□-FMA25.4-□□
	27	BT□□-FMC27-□□
3100HR-□	31.75	BT□□-FMA31.75-□□
	32	BT□□-FMC32-□□
3125HR-□	38.1	BT□□-FMA38.1-□□
	40	BT□□-FMB/FMC40-□□

Parts

Specification		
∅50~∅125	FTKA0307	TW09S

Available inserts E19, E20 Available arbors and bolt E400~E402

